

Product Data Sheet

**Metalbestos-5000 Multi25**

Ver. 2.0  
Date: 2016-06-01

<b>Application:</b>	Double wall insulated system chimney for commercial application: boilers, diesel generators, CHP units, air and smoke extraction, process application
<b>Installation:</b>	Outside or inside a building
<b>Fuels:</b>	Gas, oil
<b>Operating temperature:</b>	≤ 600 °C
<b>Sootfire resistance:</b>	No
<b>Mode of operation:</b>	Positive pressure (H1 ≤ 5000 Pa) – with lip seal gasket on outercase & locking band
	Dry
<b>Inner liner material:</b>	1.4404 (316L)
<b>Outer casing material:</b>	1.4301 (304)
<b>Outer casing finish:</b>	- BA - shiny (standard) - 2B - matt
<b>Insulation type:</b>	Superwool Plus blanket
<b>Insulation density:</b>	96 kg/m <sup>3</sup>
<b>Thermal resistance:</b>	0,37 m <sup>2</sup> K/W measured at 200 °C with Ø200 mm
<b>Mean roughness:</b>	1,0 mm according to EN 13384-1
<b>Height above last structural support:</b>	- 3,0 m (Ø80 - Ø250) - 2,5 m (Ø300) - 2,0 m (Ø350 - Ø700)
<b>Distance between lateral supports:</b>	- 4,0 m (Ø80 - Ø300) - 3,0 m (Ø350 - Ø700)

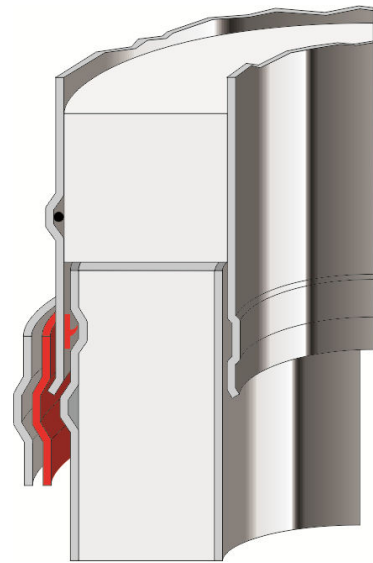

**Diameter Range:**

<b>Internal diameter:</b>	80	100	130	150	180	200	230	250	300	350	400	450	500	600
<b>External diameter:</b>	130	150	180	200	230	250	280	300	350	400	450	500	550	650
<b>Inner liner thickness:</b>	0,5 mm (1,0 mm optional)										0,6 mm (1,0 mm optional)			
<b>Outer wall thickness:</b>	0,5 mm								0,6 mm				0,7	
<b>Weight (kg/m):</b>	3,5	4,2	5,21	5,9	6,9	7,6	8,6	9,3	11,8	13,6	16,5	18,4	22,4	25,9

\* Production possible up to inner liner diameter 800 mm - certificate in preparation

## Certificates and designations:

<b>ICS 5000 25 – System chimney:</b>	<b>0036 – CPD – 91236 – 027</b> <b>0036 – CPD – 9195 – 027 rev.01</b>
<b>CE Designation EN 1856-1:</b>	T600 - H1 - D – V3 - L50050 - OXX* T600 - H1 - D – V2 - L99050 - OXX*

\*distance to combustible materials depends on diameter and type of installation:

### Fig. 1: Installation outside fully ventilated

Distance to combustibles at:

**T600:**     $\varnothing 80 - \varnothing 300 = \mathbf{O75}$   
                $\varnothing 350 - \varnothing 450 = \mathbf{O112,5}$   
                $\varnothing 500 - \varnothing 600 = \mathbf{O150}$

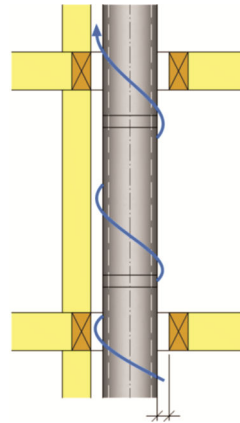

Fig. 1

<b>ICS 5000 25 - Connecting flue pipe:</b>	<b>0036 – CPR – 91236 038</b> <b>0036 – CPR – 9195 – 038</b>
<b>CE Designation EN 1856-2:</b>	T450 - H1 - D – V3 – L50050 – G100 M T450 - H1 - D – V2 – L99050 – G100 M

### Fig. 2: Installed as horizontal connecting flue pipe

Distance to combustibles at:

**T450:**     $\varnothing 80 - \varnothing 300 = \mathbf{G100}$

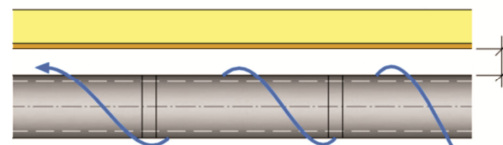

Fig. 2