

Certificates and designations:

MULTI 25 – System chimney:	0036 – CPD – 91236 – 001 rev. 02 0036 – CPD – 9195 – 001 rev. 05
CE Designation EN 1856-1:	T450 - N1 - W - V2 - L50050 – GXX* T450 - N1 - D - V3 - L50050 – GXX* T200 - P1 - W - V2 - L50050 – O00

*distance to combustibles depends on diameter and type of installation:

Fig. 1: Installation outside fully ventilated

Distance to combustibles at:

- T450:** $\varnothing 80 - \varnothing 300 = \mathbf{G50}$
 $\varnothing 350 - \varnothing 450 = \mathbf{G75}$
 $\varnothing 500 - \varnothing 600 = \mathbf{G100}$
 $\varnothing 650 - \varnothing 700 = \mathbf{G200}$

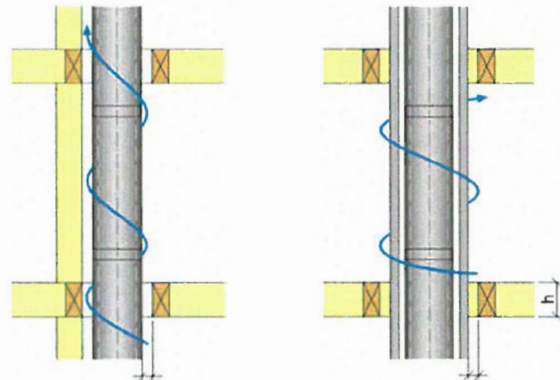

Fig. 1

Fig. 2

Fig. 2: Installation inside non-combustible shaft (distance refers to the shaft's outside wall)

Distance to combustibles at:

- T450:** $\varnothing 80 - \varnothing 300 = \mathbf{G50}$

Fig. 3: Installation inside combustible shaft – naturally ventilated

Distance to combustibles at:

- T450:** $\varnothing 80 - \varnothing 300 = \mathbf{G60}$

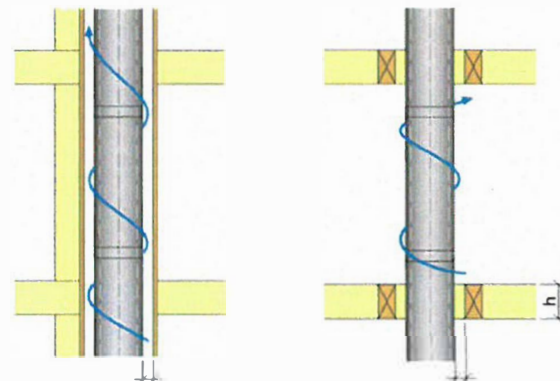

Fig. 3

Fig. 4

Fig. 4: Installation through insulated closed floor

Distance to combustibles at:

- T450:** $\varnothing 80 - \varnothing 300 = \mathbf{G100}$ for $h \leq 200$ mm
T450: $\varnothing 80 - \varnothing 300 = \mathbf{G150}$ for $200 < h \leq 400$ mm

MULTI 25 – Connecting flue pipe:	0036 – CPR – 91236 – 041 0036 – CPR – 9195 – 041
CE Designation EN 1856-2:	T450 - N1 - D - V2 – L50050 – G100 M

Fig. 5: Installed as horizontal connecting flue pipe

Distance to combustibles at:

- T450:** $\varnothing 80 - \varnothing 300 = \mathbf{G100}$

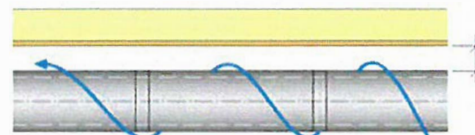

Fig. 5